

RECESSED 3/4" & 1" STUBBY STEEL DOOR SWITCH SET

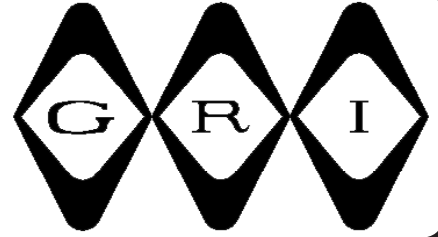

180RS & 8080RS-T SERIES

- ◆ Recessed Magnetic Contact
- ◆ 12" #22AWG Leads or Screw Terminals
- ◆ Longer Leads, Zip Cord or Jacketed Cable Upon Request
- ◆ Built-in E.O.L. Resistors and Diodes Upon Request
 - ◆ Supervisory Loops Upon Request
 - ◆ Colors: White, Brown, Gray, Black
 - ◆ Available Closed Loop Only

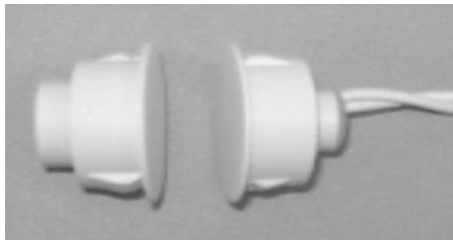

180RS-12



8484RS-T

PART NUMBERS:

		Closed Loop
Up To 5/8" Gap	3/4" Dia.	180RS-12
On Steel*	1" Dia.	184RS-12
	3/4" Dia.	8080RS-T
	1" Dia.	8484RS-T

*Gaps will increase substantially for installations other than steel

WARRANTY:

Lifetime warranty against workmanship, material and factory defects.

GEORGE RISK INDUSTRIES, INC.
G.R.I. PLAZA
KIMBALL, NE 69145



MADE IN U.S.A.

TOLL-FREE 1-800-445-5218
TOLL-FREE 1-800-523-1227
(308) 235-4645
FAX (308) 235-3561
E-MAIL: sales@grisk.com
WEB SITE: www.grisk.com



RECESSED 3/4" & 1" STUBBY STEEL DOOR SWITCH SET

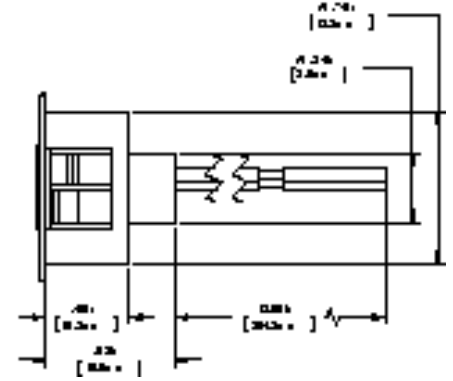
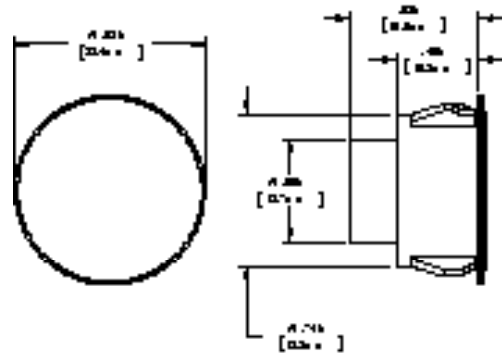

180RS-12

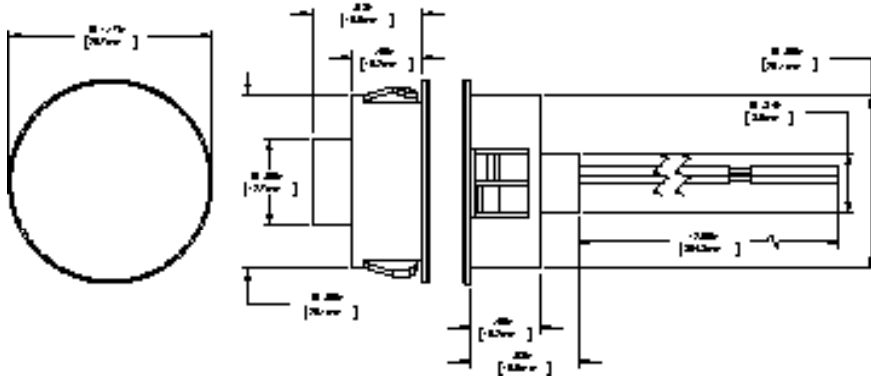

8484RS-T

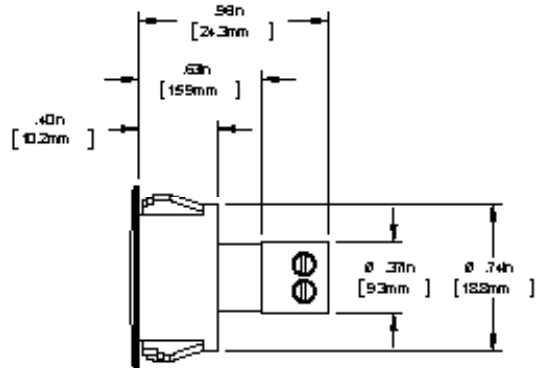
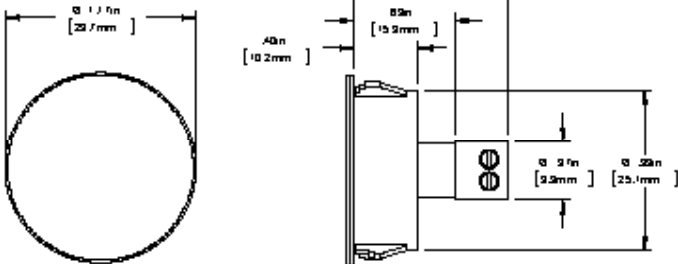

8080RS-T

GRI products meet or exceed these minimum general specifications:

PART NUMBER	LOOP TYPE	ELECTRICAL CONFIG.	REED FORM	MAXIMUM INITIAL CONTACT RESISTANCE (Ω)	MAXIMUM CONTACT RATING (W)	MAXIMUM SWITCHING VOLTAGE (VDC)	MAXIMUM SWITCHING CURRENT (A)
180RS-12	Closed	N/O	A	.150	10	200	.500
184RS-12	Closed	N/O	A	.150	10	200	.500
8080RS-T	Closed	N/O	A	.150	10	200	.500
8484RS-T	Closed	N/O	A	.150	10	200	.500

CONTACT YOUR G.R.I. DISTRIBUTOR OR CALL:

GEORGE RISK INDUSTRIES, INC.
G.R.I. PLAZA
KIMBALL, NE 69145



MADE IN U.S.A.

TOLL-FREE 1-800-445-52 • 1-800-523-1227
(308) 235-4645 • FAX (308) 235-3561
E-MAIL: sales@grisk.com
WEB SITE: www.grisk.com